

Legend

- Planning Application Boundary
- 60.0 Contours (2m Intervals) & Spot Levels
- Site Surround Contours
- Limit of Extraction within this Phase
- Operational Area
- Operational Tip: Placement of Material within this Phase
- Indicative Plant Site & Stocking Area
- Partial Removal of Tip
- Placement of Material for Restoration
- Existing Woodland / Hedges / Trees
- Agricultural Land within the Application Boundary
- Native Tree & Shrub Planting



Site Name:
Hendre Quarry

Drawing Name:
Phase 3

FINAL

Drawn By: RGD/RJS	Scale @ A3: 1:5,000	
Date: March 2021	Drawing Number: H072_00045-6A	

- #### Phase 3 Operations
- Ongoing extraction of Cefn Mawr limestone within the eastern extension. All Cefn Mawr limestone that is not sold is to be tipped in the west of the quarry to form the Western tip.
 - Earthmove of the upper section of the Northern Switch back ramp to allow for access to Cefn Mawr limestone. Earthmove material to be placed in to the western tip.
 - Earthmove of the lower section of the Northern Switch-back ramp to allow access to the Loggerheads Limestone extraction area. Earthmove material to be placed into the western tip.
 - Extracted rock to be processed on-site, temporarily stocked and transported off-site by HGV to point of sale.
 - Ongoing Landscape and Ecological Management of land within the Site.
 - Haul road routes added / extended to Phase 3 eastern extension area.

Release of Mineral	Cefn Mawr Limestone 'Top Rock'	Loggerheads Limestone 'Massive Limestone'	Length of Phase
	1,749,000 Saleable Tonnes	2,355,000 Saleable Tonnes	approx. 5.1 Years

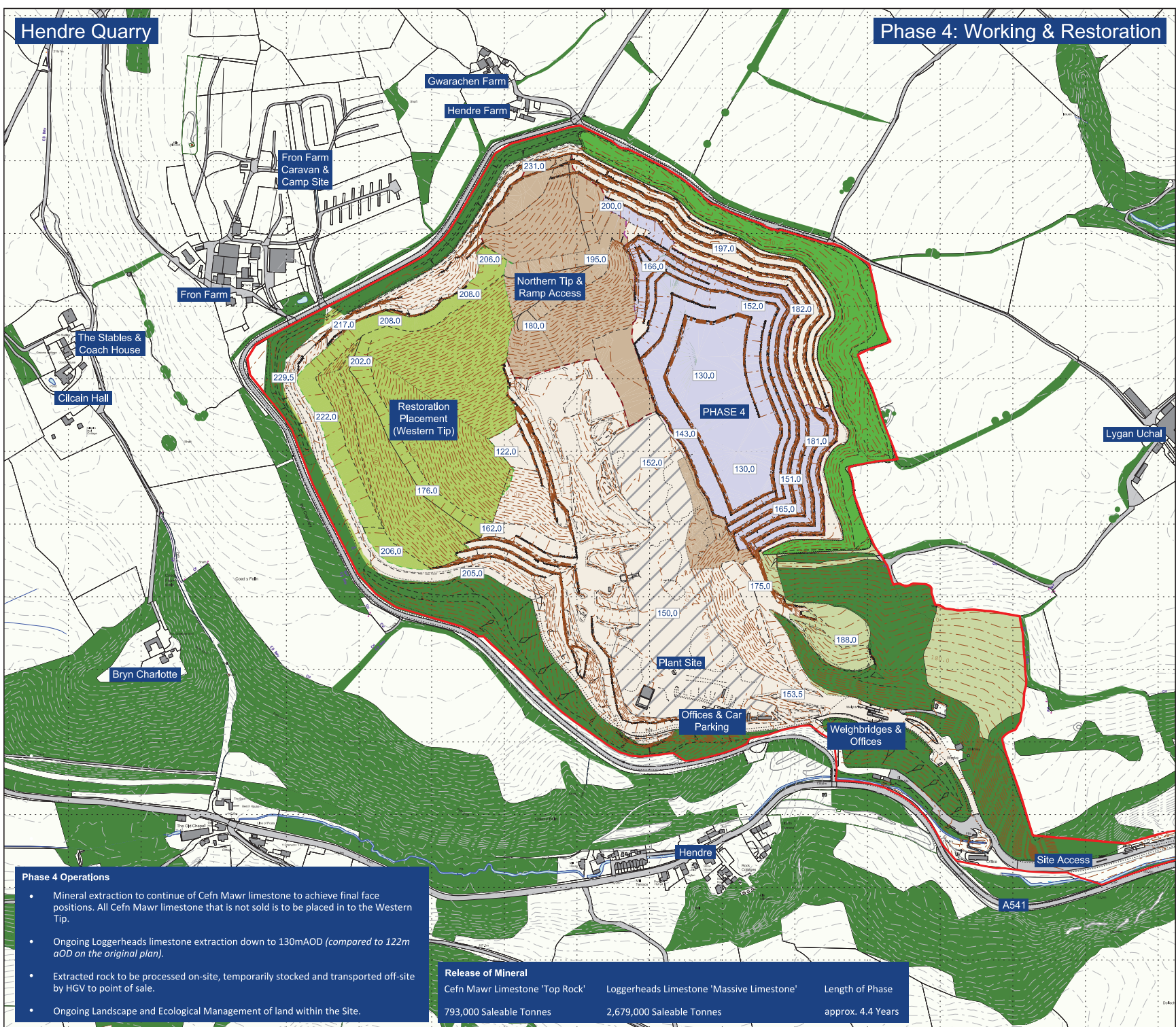

Hendre Quarry

Phase 4: Working & Restoration

Legend

-  Planning Application Boundary
-  60.0 Contours (2m Intervals) & Spot Levels
-  Site Surround Contours
-  Limit of Extraction within this Phase
-  Operational Area
-  Operational Tip: Placement of Material within this Phase
-  Indicative Plant Site & Stocking Area
-  Placement of Material for Restoration
-  Water Bodies
-  Existing Woodland / Hedges / Trees
-  Agricultural Land within the Application Boundary
-  Native Tree & Shrub Planting

Phase 4 Operations

- Mineral extraction to continue of Cefn Mawr limestone to achieve final face positions. All Cefn Mawr limestone that is not sold is to be placed in to the Western Tip.
- Ongoing Loggerheads limestone extraction down to 130mAOD (compared to 122m aOD on the original plan).
- Extracted rock to be processed on-site, temporarily stocked and transported off-site by HGV to point of sale.
- Ongoing Landscape and Ecological Management of land within the Site.

Release of Mineral	Cefn Mawr Limestone 'Top Rock'	Loggerheads Limestone 'Massive Limestone'	Length of Phase
	793,000 Saleable Tonnes	2,679,000 Saleable Tonnes	approx. 4.4 Years



Site Name:
Hendre Quarry

Drawing Name:
Phase 4

FINAL

Drawn By: RGD	Scale @ A3: 1:5,000
Date: March 2021	Drawing Number: H072_00045-7A



Hendre Quarry

Phase 5: Working & Restoration

Legend

-  Planning Application Boundary
-  60.0 Contours (2m Intervals) & Spot Levels
-  Site Surround Contours
-  Limit of Extraction within this Phase
-  Operational Area
-  Operational Tip: Placement of Material within this Phase
-  Indicative Plant Site & Stocking Area
-  Partial Removal of Tip
-  Placement of Material for Restoration
-  Restored Land
-  Existing Woodland / Hedges / Trees
-  Agricultural Land within the Application Boundary
-  Native Tree & Shrub Planting

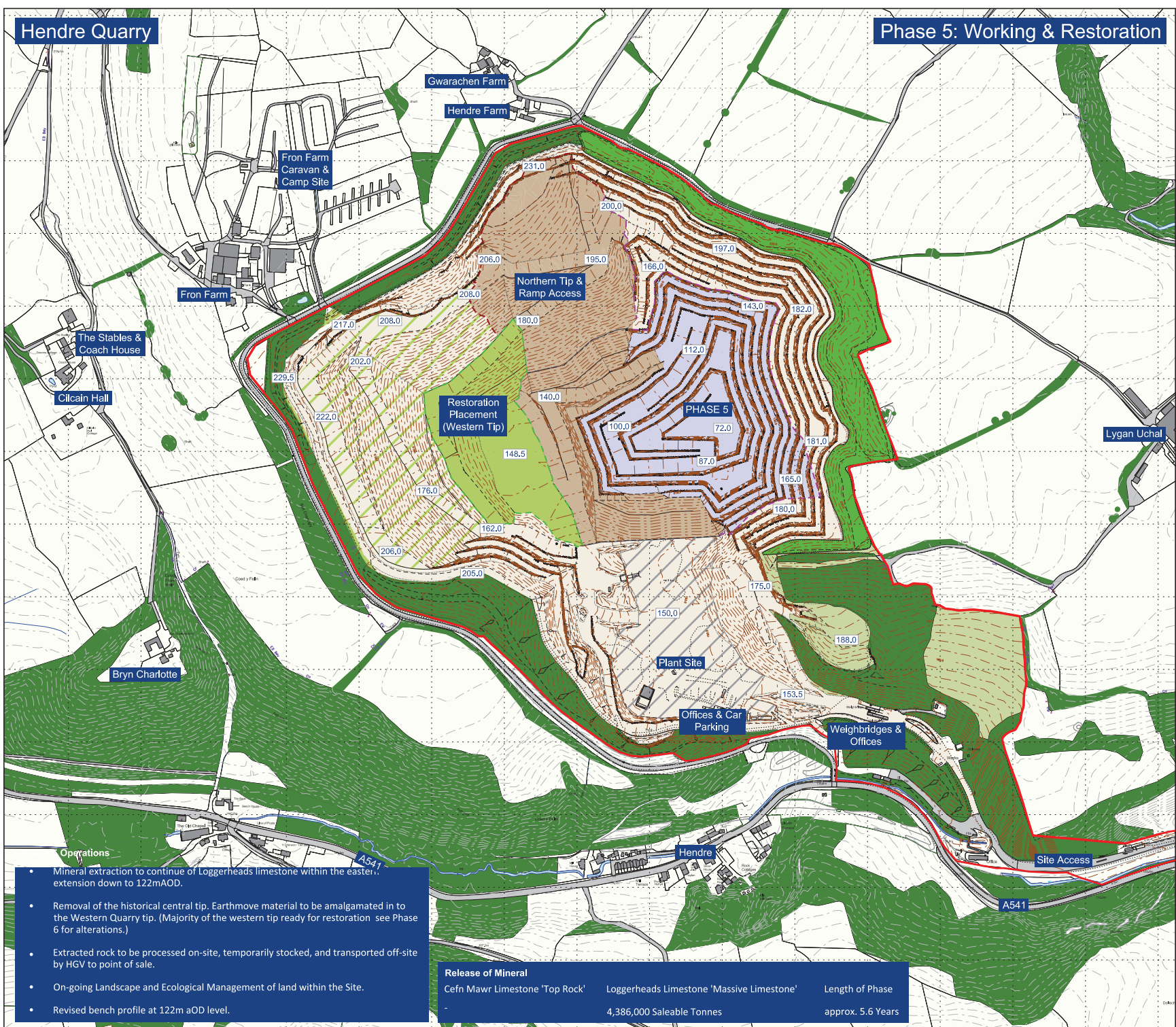

- Mineral extraction to continue of Loggerheads limestone within the eastern extension down to 122mAOD.
- Removal of the historical central tip. Earthmove material to be amalgamated into the Western Quarry tip. (Majority of the western tip ready for restoration see Phase 6 for alterations.)
- Extracted rock to be processed on-site, temporarily stocked, and transported off-site by HGV to point of sale.
- On-going Landscape and Ecological Management of land within the Site.
- Revised bench profile at 122m aOD level.

Release of Mineral		
Cefn Mawr Limestone 'Top Rock'	Loggerheads Limestone 'Massive Limestone'	Length of Phase
-	4,386,000 Saleable Tonnes	approx. 5.6 Years



Site Name: Hendre Quarry	
Drawing Name: Phase 5	
FINAL	
Drawn By: RGD/RJS	Scale @ A3: 1:5,000
Date: March 2021	Drawing Number: H072_00045-8A



Hendre Quarry

Phase 6: Working & Restoration

Legend

-  Planning Application Boundary
-  60.0 Contours (2m Intervals) & Spot Levels
-  Site Surround Contours
-  Limit of Extraction within this Phase
-  Operational Area
-  Operational Tip: Placement of Material within this Phase
-  Indicative Plant Site & Stocking Area
-  Partial Removal of Tip
-  Placement of Material for Restoration
-  Restored Land
-  Existing Woodland / Hedges / Trees
-  Agricultural Land within the Application Boundary
-  Native Tree & Shrub Planting



- Phase 6 Operations**
- Clearance of a portion of the Western Quarry Tip to allow for final extraction of Loggerheads Limestone.
 - These materials to be placed in the south east of the quarry to form final restoration landform and levels.
 - Restoration works to Western Tip.
 - Removal of the remainder of the Northern Switch-back ramp and a portion of the Western Quarry tip to allow for continued Loggerheads Limestone extraction.
 - Earthmove materials to be transported and placed in to the south-east of the quarry to form the Eastern Quarry Landform. Western tip available for restoration once the Phase 6 earthmove is complete.
 - Extracted rock will be processed on-site, temporarily stocked, and transported by HGV to point of sale.
 - On cessation of rock processing and final sale of aggregate, all plant machinery is to be decommissioned and removed from Site.
 - On-going Landscape and Ecological Management of land within the Site.
 - Revised profiles and access to restored south eastern area.

Release of Mineral	Loggerheads Limestone 'Massive Limestone'	Length of Phase
Cefn Mawr Limestone 'Top Rock'	4,826,000 Saleable Tonnes	approx. 6.0 Years



Site Name: Hendre Quarry	
Drawing Name: Phase 6	
FINAL	
Drawn By: RGD/RJS	Scale @ A3: 1:5,000
Date: March 2021	Drawing Number: H072_00045-9A





Legend

- Planning Application Boundary
- Land Under the Control of the Applicant
- Contours (2m Intervals) & Spot Levels
- Site Surround Contours
- Existing Woodland / Hedges / Trees
- Proposed Native Woodland / Shrub Planting
- Species Rich Calcaerous Grassland
- Existing Areas of Agricultural Grassland - Retained
- Retained Benches - Hydrosseeded with Grassland / Scrub Species
- Natural Regeneration - Faces & Benches
- Natural Regeneration - Open Stony Substrate
- Ephemeral Water Bodies
- Placement of Stock / Rubble / Scree
- Cross Section Locations



Restoration Aim

The integration of the quarry / site periphery into the wider surrounding Clywydian Range setting, with the creation of a distinct internal landscape to achieve high quality limestone flora and fauna communities and to promote Biodiversity

Restoration Objectives

- The creation of woodland / hedgerow peripheral vegetative corridors around the site which link into and connect existing vegetation structures.
- The establishment of permanent landform features and elements which externally screen the quarry void and internally provide a variety of physically stable wildlife habitats and environments.
- To utilise Site generated quarry waste material and soils to establish a growth medium for the planting, seeding and natural regeneration and circulation of limestone species of flora and fauna, and site peripheral woodland.
- The design, implementation and monitoring of a long term Site Management Plan to promote, enhance and sustain landscape and ecological infrastructure and species.



Site Name:
Hendre Quarry

Drawing Name:
Concept Restoration

FINAL

Drawn By: RGD/RJS	Scale @ A3: 1:5,000
Date: March 2021	Drawing Number: H072_00045-10A

